

How to Download a Student Registration Packet Using a Chromebook

Using a Chromebook

1. Go to www.rochesterschools.com

Rochester School Department

150 Wakefield Street - Suite #8
Rochester, New Hampshire 03867
phone 603.332.3678 - fax 603.335.7367

ROCHESTER SCHOOLS
est. 1751

Employment Bids & Specs Site Map

Quick Links

★ Coronavirus (COVID-19) ★
Facts & Resources

- Rochester School Department Blog
- [Blizzard Bag Information](#)
- [Student Registration](#)
- Infinite Campus Login - Parents/Students - Staff

2. Click on “Student Registration”

Home Our District Our Schools For Parents School Board Employment

★ *Remote Learning Information*

Mission

"The Rochester New Hampshire School District provides a personalized experience for all students to be, responsible, and contributing citizens, who can read, write, communicate, problem solve and calculate with clarity. The learning environment includes

Quick Links

- ★ Coronavirus (COVID-19) ★
Facts & Resources
- Rochester School Department Blog
- [Blizzard Bag Information](#)
- [Student Registration](#)

3. Click on “Student Registration Packet”.

Student Registration

To register a student for the 2020-2021 school year, grades K-12, parents/ guardians need to complete a [Student Registration Packet](#) and submit it along with a birth certificate, proof of residency, immunizations records and proof of physical. This may be completed online and then e-mailed. You may also print out the registration packet and mail to the appropriate address provided below.

- The Student Registration Form will open so that you can type in the student information.

Rochester School Department – Student Registration Form



Pupil Information:

Name: _____
(Last) Smith John Adam (First) (Middle)

M/F _____ Date of Birth _____ City/State of Birth _____

Street Address _____ City _____ State _____ ZIP _____

Home Phone _____ Cell _____

Mailing Address (if different from above) _____

<p>Ethnicity: Is your child Hispanic/Latino? Yes <input type="checkbox"/> No <input type="checkbox"/></p> <p>Race: (check all that apply)</p> <p><input type="checkbox"/> American Indian/Alaskan Native</p> <p><input type="checkbox"/> Asian</p> <p><input type="checkbox"/> Black/African American</p> <p><input type="checkbox"/> Native Hawaiian/Other Pacific Islander</p> <p><input type="checkbox"/> White</p>	<p>Student resides with (check one):</p> <p><input type="checkbox"/> Both Parents <input type="checkbox"/> Mother <input type="checkbox"/> Father <input type="checkbox"/> Legal Guardian</p> <p><input type="checkbox"/> Joint Shared Custody <input type="checkbox"/> Foster Parent <input type="checkbox"/> Other</p> <p>Do you have any court orders? If yes, a complete original copy of any legal documents/court orders must be presented (i.e. divorce decree/parenting plan pertinent to custody & registration for school, custody, restraining order, etc.)</p>
--	---

Date of Withdrawal: _____ Grade now entering: _____

Last School Attended: _____ Grade: _____
(School) (City) (State)

Has your child ever registered or been evaluated by Rochester Public Schools before? If yes, when, or how long ago?

Does your child receive Special Services now? If yes, check all that apply: IEP 504 Other _____

- After you have completed the registration packet, click the download button in the upper right corner of the screen.

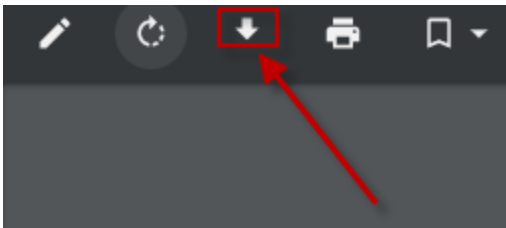

- The “Save file as” window will open

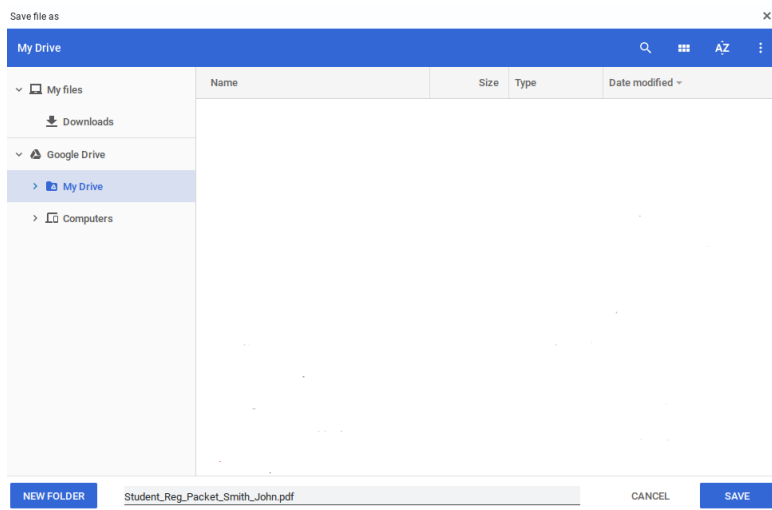

7. Change the name of the file so it includes the student's name. For example, "Student_Reg_Packet_Student_Name" (Your student's name). Click the "SAVE" button.

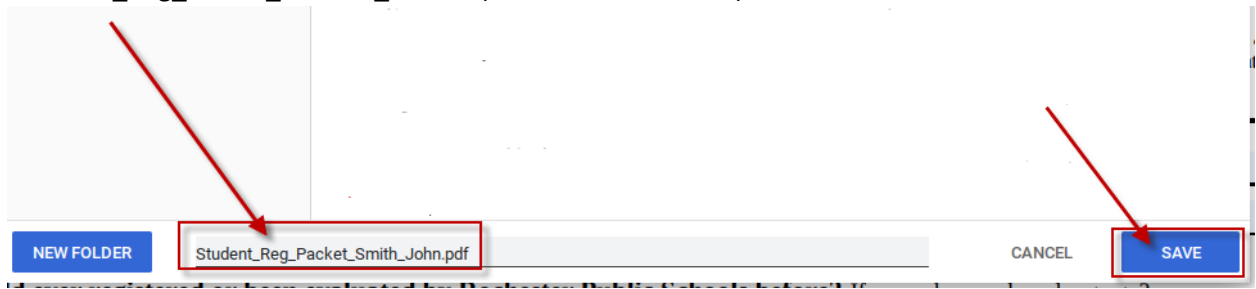

8. The form will be saved to Google Drive.

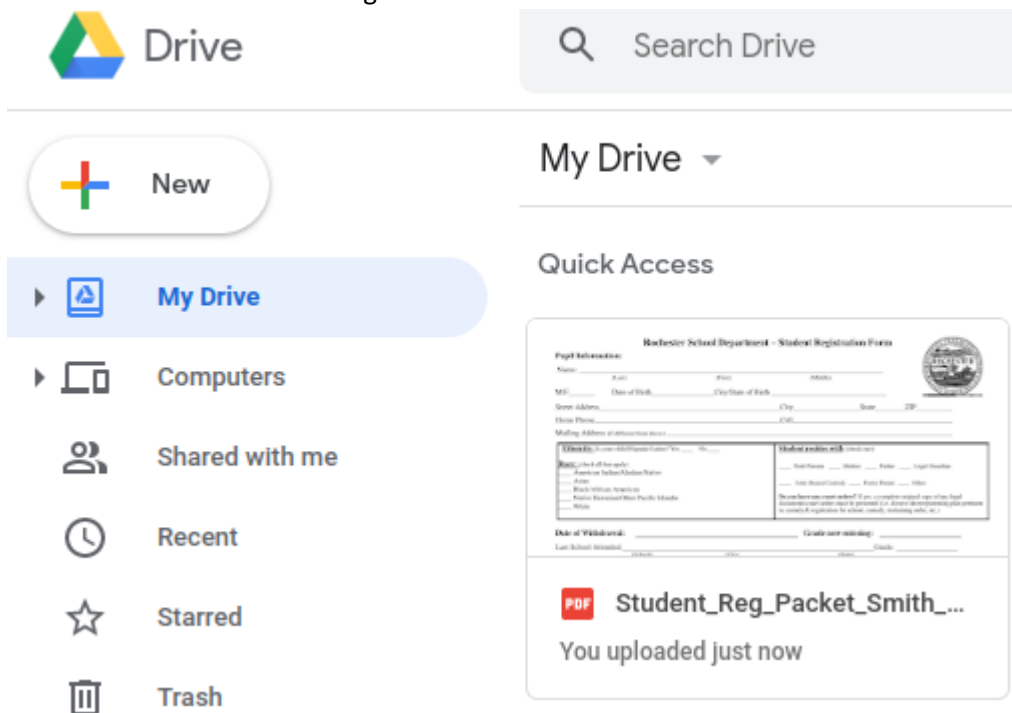

9. Next you can either print out the packet and send it in the US mail to the address to the appropriate address or create an email and attach the file to the email. Remember to include the other required documents, a birth certificate, proof of residency, immunizations records and proof of physical.

Completed registration documents can be mailed to:

Elementary, grades K-5

Rochester School Department
Student Registration
150 Wakefield Street, Suite 8
Rochester, NH 03867

Or e-mailed to:

student.registration@sau54.org

Rochester Middle School, grades 6-8

Rochester Middle School
Guidance Department
47 Brock Street
Rochester, NH 03867

Or e-mailed to:

rms.student.registration@sau54.org

Spaulding High School, grades 9-12

Spaulding High School
Guidance Department
130 Wakefield Street
Rochester, NH 03867

Or e-mailed to:

shs.student.registration@sau54.org